



PREMIUM SUPER DRY CUTTER 9435

THE BESTSELLER

Metal cutting chop saw by Jepson Power for fast and burr free cutting of metal pipes and profiles without coolant

- Cuts ferrous and non-ferrous metal tubes, pipes and profiles made of mild steel, stainless steel, aluminum, plastic and composite materials
- No need for lubricant and manual deburring
- Exclusive blade stabilising system reduces vibration
- High torque motor for continuous operation
- Patented quick-release vice for bevel cuts
- Heavy duty angle cutting at 90-75-60-45°
- Optional stand for a comfortable and save work place
- CE approved operating system

Scope of delivery:
Ø 355 / 90T CT saw blade for steel and stainless steel

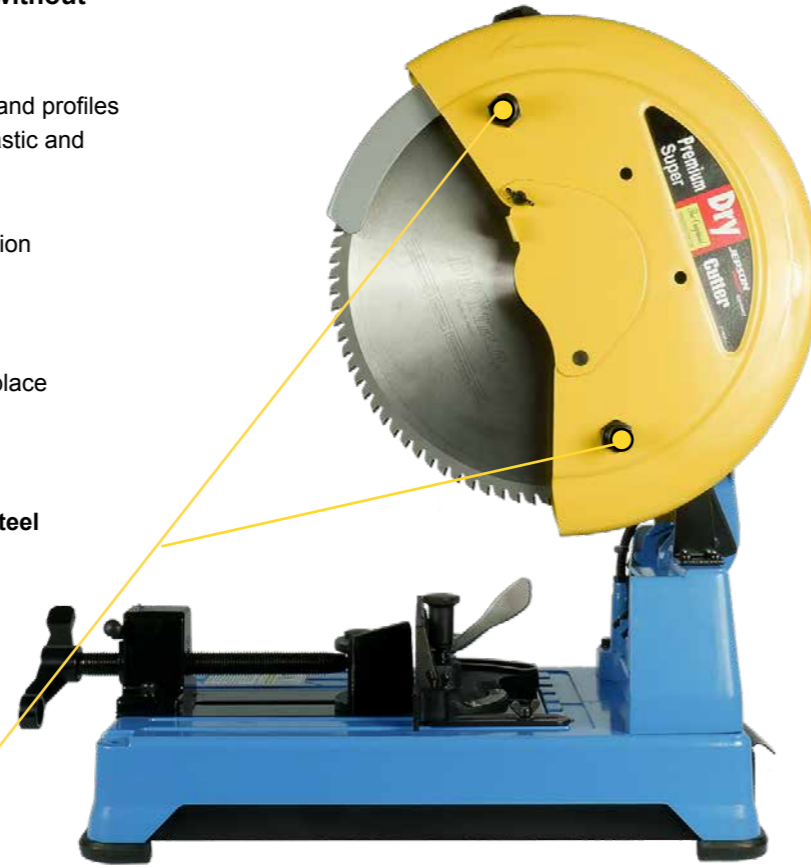

TWO PATENTED STABILIZERS FOR A BETTER CUTTING SURFACE AND LONG CUTTING LIFE



„K“ CLAMPING SET FOR SQUARE TUBES
For a safer and more stable cutting process (included)

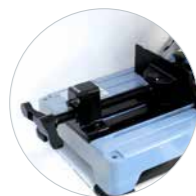

QUICK RELEASE QUICK RELEASE SYSTEM
Enables precise and efficient clamping



RIP FENCE
Increased stability - makes it easier to saw short materials



MITER CUTS CAN BE ADJUSTED WITHOUT TOOLS
90-75-60-45°



CHIP COLLECTOR
For a clean workplace

Power input	Voltage	No load speed	Net weight	Blade size	Bore
2.400 W	230V/50Hz or 115V/60Hz	1.400 min ⁻¹	25 kg	Ø 355 mm	Ø 25,4

Premium Super Dry Cutter 9435	Reference	Max. cutting capacities
with Ø 355/90T CT saw blade 230V	600560T3	90° 45°
with Ø 355/90T CT saw blade 115V	600560UST3	
		Round 140 / Inox 125 102
		Square 125 x 125 80 x 80
		Rectangular 105 x 155 75 x 100

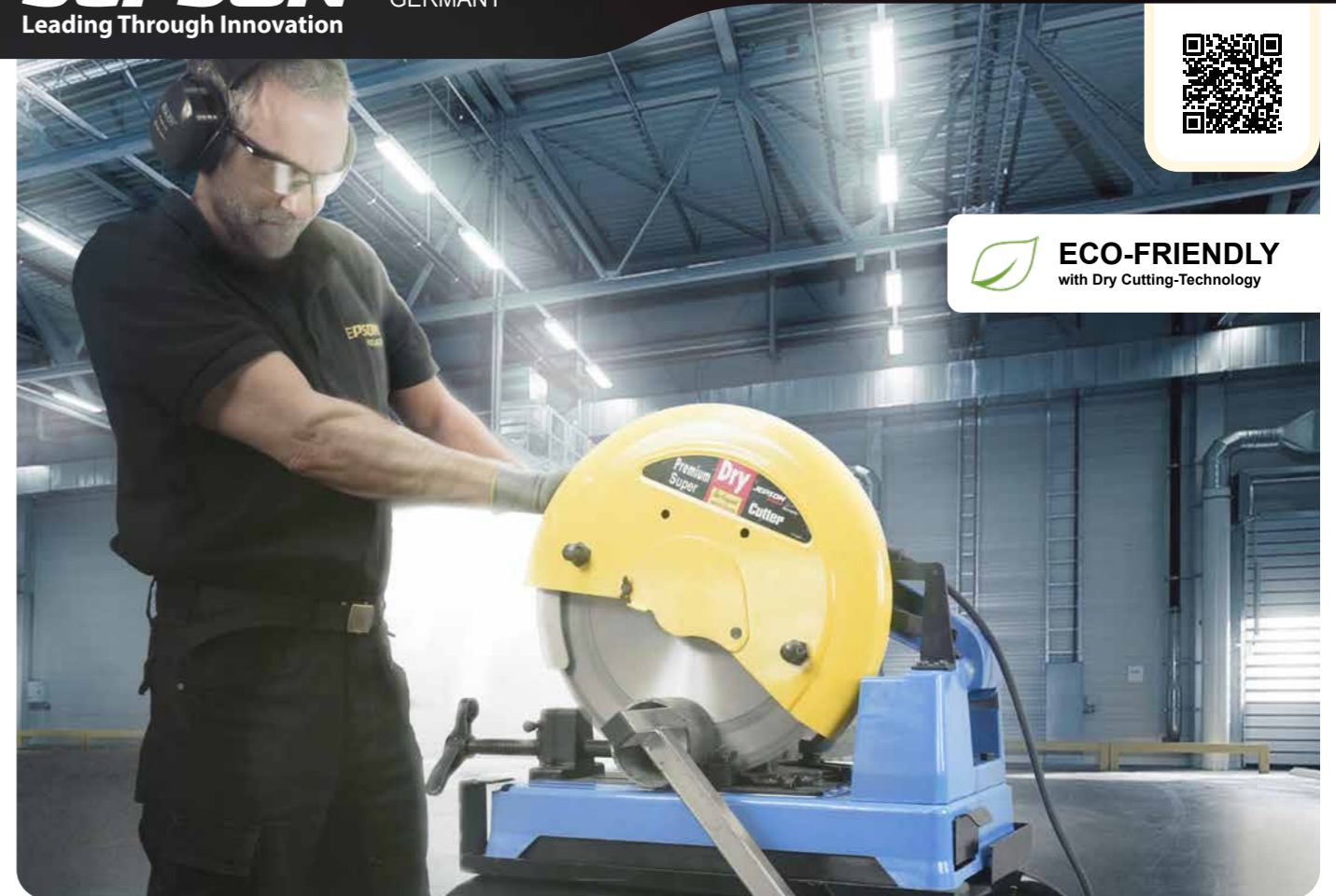

ECO-FRIENDLY
with Dry Cutting-Technology

ACCESSORIES (OPTIONAL)

Selecting the correct number of teeth depends on the wall/diameter of the material. We will be happy to advise you. +49 (0) 2403 64 55 0

Carbide tipped saw blades	Ø [mm]	Teeth	Bore [mm]	Kerf [mm]	Max. Speed	Wall thickness [mm]	Reference
Stainless steel NSF coated	355	90	25,4	2,2	1.800 min ⁻¹	≤ 3 - 4	600570NSF
Stainless steel (thin-walled)	355	120	25,4	2,2	1.800 min ⁻¹	≤ 2 - 3	600512I
Steel & stainless steel (thin-walled)	355	90	25,4	2,2	1.800 min ⁻¹	≤ 3 - 4	600570
Steel & stainless steel (medium-walled)	355	72	25,4	2,2	1.800 min ⁻¹	≤ 5 - 6	600580
Steel & stainless steel (thick-walled)	355	60	25,4	2,2	1.800 min ⁻¹	≤ 10	600590
Cast iron / SML	355	60	25,4	2,2	1.800 min ⁻¹	≤ 10	600591
Structural steel	355	66	25,4	2,2	1.800 min ⁻¹	≤ 10	600595
Aluminum	355	96	25,4	3,4	3.500 min ⁻¹	≤ 4 - 5	600594



Assembly stand
Ref. 600526T3



Excentric clamping system
Ref. 600910



Thin-fix clamping system for open profiles
Ref. 600546

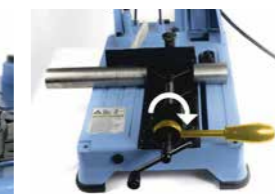

Vice with quick release system for series cut
Ref. 1501128